



CB009 – REAR OF THE REAR CRADLE CHASSIS BRACE

RECOMMENDED TOOLS:

- Jack and jack stands
- Deep well sockets – 15mm, 18mm
- Ratchet



NOTE: General Motors requires that you replace the rear main cradle bolts as they are Torque to Yield bolts also known as T.A.Y. fasteners (Torque Angle Yield) or single use fasteners. During development and testing we have not replaced any of these bolts, your mileage may vary.

- Rearward, Rear Cradle Bolts/Stud: Part # 11611819 (74ftlbs + 90-105 degrees) Shown as #7

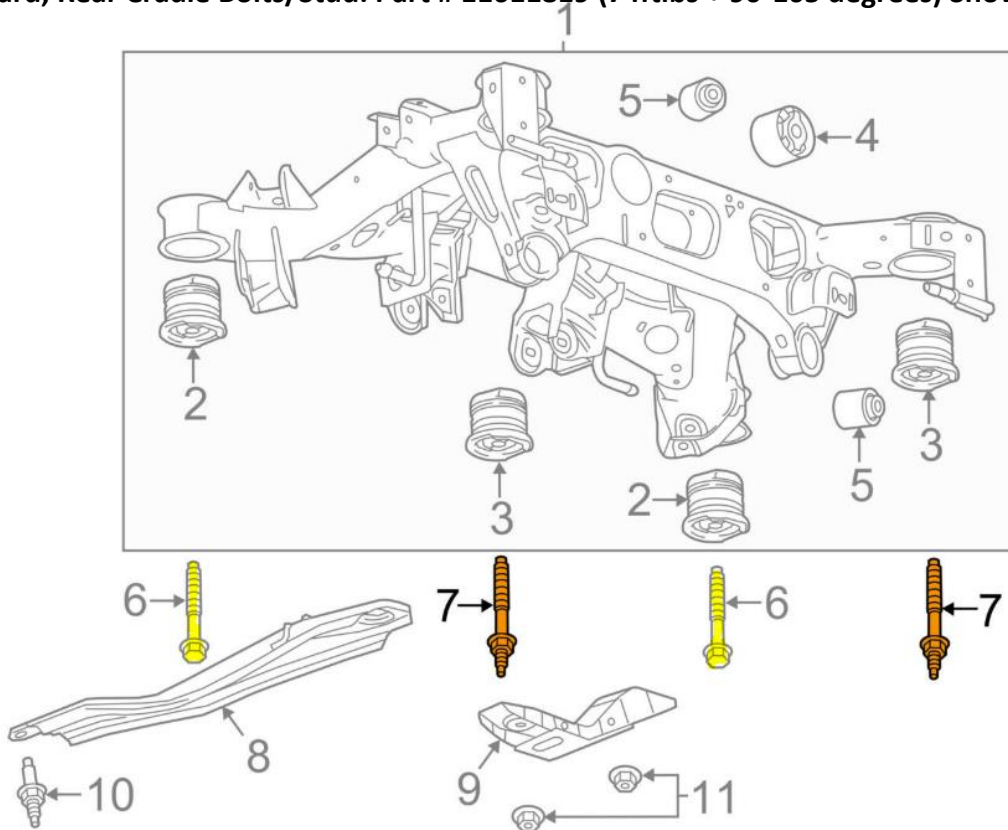

WWW.BMRSUSPENSION.COM

This product is an aftermarket accessory and not designed by the vehicles manufacturer for use on this vehicle. As such, buyer assumes all risk of any damage caused to vehicle/person during installation or use of this product



CB009 – REAR OF THE REAR CRADLE CHASSIS BRACE

INSTALLATION:

1. Lift the rear of the vehicle and support with jack stands under the frame rails. Ensure your jack and jack stand placement doesn't interfere with the removal of the original chassis braces.
2. Using a 15mm socket, remove the stock chassis braces behind the rear cradle as shown in **IMAGE 1**.
3. Support the rear of the cradle with a jack or block.
4. Using the 18mm socket, remove the long rear cradle bolts.
5. If the BMR Bushing Lockout kit is not installed on the car, use the stainless washers on top of the chassis brace on both rear cradle bolts as shown in **IMAGE 2**. Use the supplied bolts and a 18mm socket to thread in several turns by hand. Leave loose.
6. Using a 15mm socket, install and tighten the two nuts for the center of the brace as shown in **IMAGE 3**. Tighten to 40ftlbs.
7. Using a 18mm socket, tighten the rear cradle to 74ftlbs on the first pass and then an additional 90-15 degrees as seen in **IMAGE 4**.
8. Remove supports and lower vehicle.

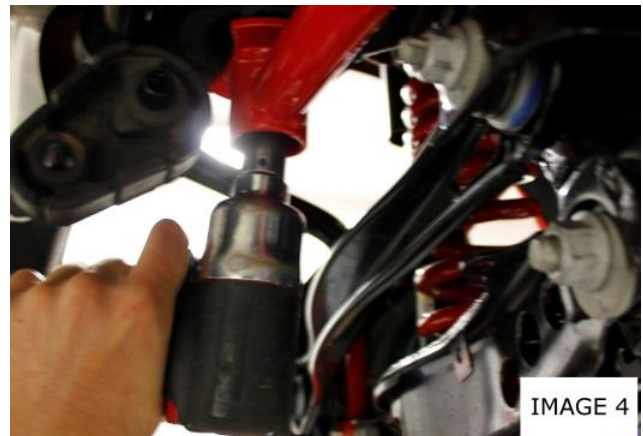

WWW.BMRSUSPENSION.COM

This product is an aftermarket accessory and not designed by the vehicles manufacturer for use on this vehicle. As such, buyer assumes all risk of any damage caused to vehicle/person during installation or use of this product